

SMT Gate Drive Transformers

Ruggedized



- Operating and storage temperature: -40°C to +130°C
- RoHS-5 compliant
- Max Reflow Temp: 245°C
- Moisture Sensitivity Level: 3
- Lead Finish: Sn100

Electrical Specifications 25°C — Operating Temperature -40°C to +130°C ¹¹

Part Number	Turns Ratio	Pri-Sec Insulation	Primary Inductance (μH MIN)	Leakage Inductance (μH MAX)	DCR Primary (ΩH MAX)	DCR Secondary (ΩH MAX)
PL1863	2:1:1	1500Vrms	1200.0	0.6	0.91	0.46

Note: 1. Add "T" suffix for tape and reel - PL1863NLT
 2. Add suffix "NL" for RoHS compliant part; i.e. PL1863 becomes PL1863NL

Mechanical

Schematic

PL1863

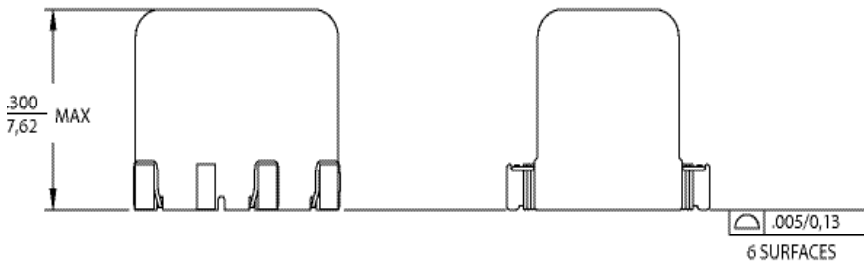
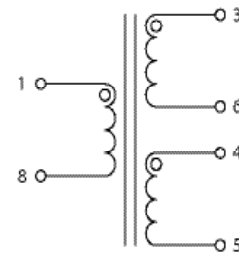
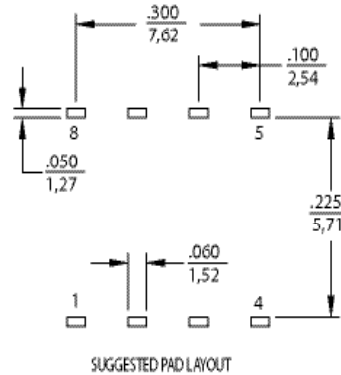
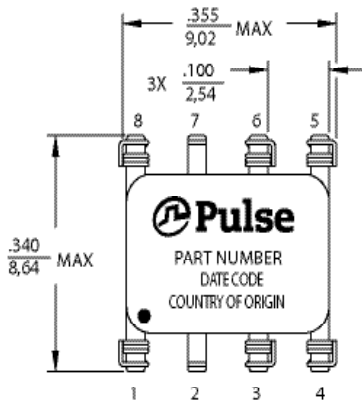

Weight 1.20 grams
 Tube 40/tube
 Tape & Reel 600/reel

Dimensions: Inches
 mm
 Unless otherwise specified, all tolerances are ± .010
 .025

Tin/Lead Recommended Reflow Profile (Based on J-STD-020D)

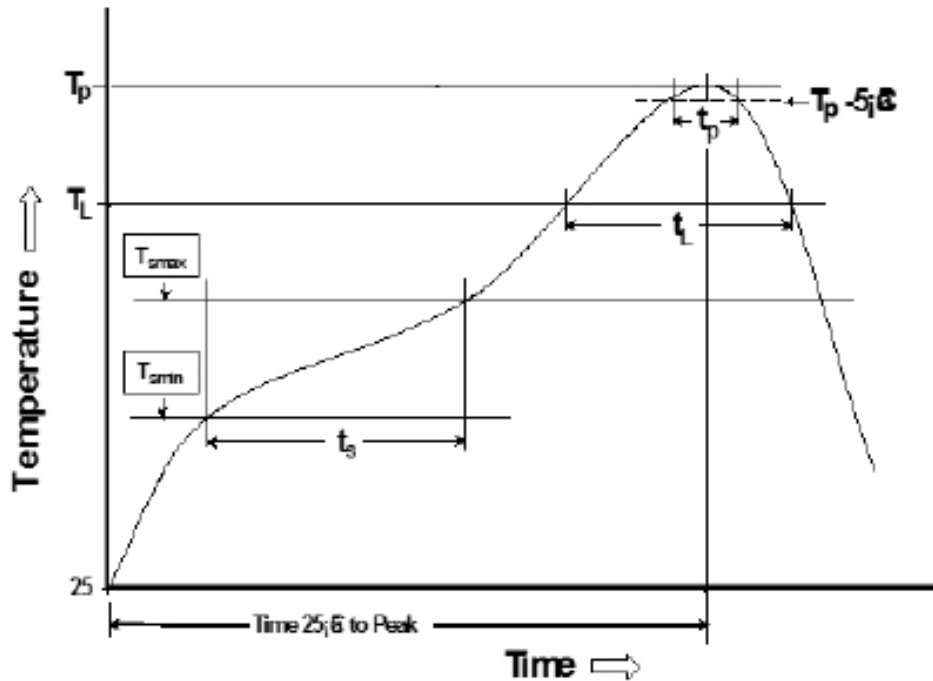

T_{SMIN} (°C)	T_{SMAX} (°C)	T_L (°C)	T_P (°C MAX)	t_s (s)	t_L (s)	t_p (s MAX)	Ramp-up rate (T_L to T_P)	Ramp-down rate (T_P to T_L)	Time 25°C to peak temperature (s MAX)
100	150	183	235	60-120	60-150	20	3°C/s MAX	6°C/s MAX	360

Notes:

1. All temperatures measured on the package leads.
2. Maximum times of reflow cycle: 2.

For More Information

Pulse North America
Headquarters
Two Pearl Buck Court
Bristol, PA 19007
U.S.A.

For Global Sales Representatives and Locations Visit:
<http://www.pulseruggedized.com>

Tel: +1.215.781.6400
Fax: +1.215.781.6403

Performance warranty of products offered on this data sheet is limited to the parameters specified. Data is subject to change without notice. Other brand and product names mentioned herein may be trademarks or registered trademarks of their respective owners. © Copyright, 2018. PulseR, LLC. All rights reserved.